

PRINCIPLE DIMENSIONS
 LENGTH OVERALL 37.65 m
 BEAM (mid) 7.95 m
 DEPTH (main deck) 3.53 m
 DRAFT (loaded) 1.70 m
 COMPLEMENT 10 MEN + 60 PASSENGER
 MAIN ENGINE 2 X CUMMINS KTA31-M2
 2 X 1350HP @ 1900RPM
 1 X CUMMINS KTA54-M2
 1 X 1800HP @ 1900RPM
 GEARBOX TWIN DISC MGX 6600SC
 2 X RATIO 2.93:1
 TWIN DISC MGX 6848SC
 1 X RATIO 2.93:1
 GENSET 2 X CUMMINS 6CTA1.3-GM155 (195KW)
 F.W.T. APPROX. 75M³
 F.O.T. APPROX. 45M³
 DECK AREA: APPROX. 100M²

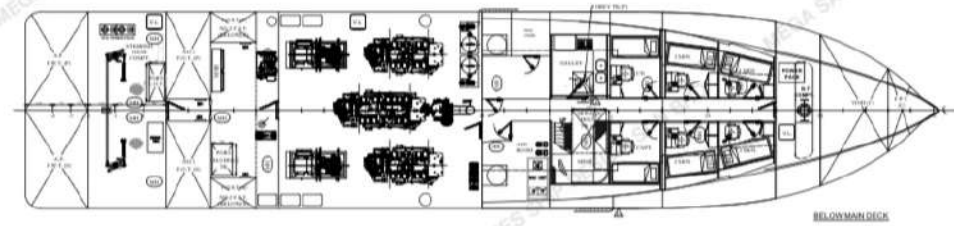
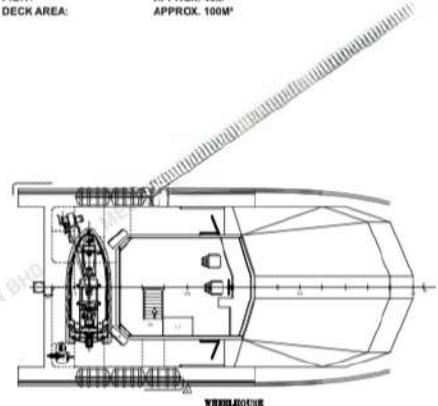
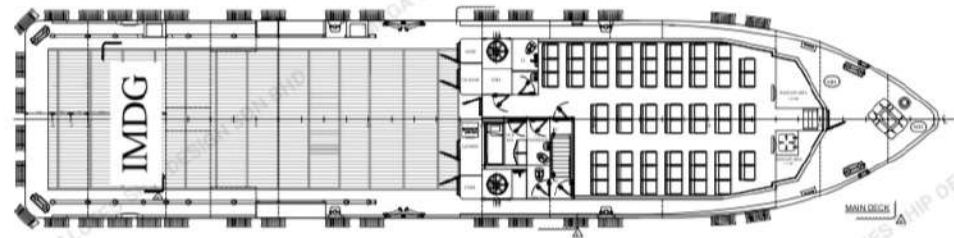

This drawing and the information contained herein is supplied on the understanding that they are the exclusive property of MEGA SALUTES SHIP DESIGN SDN. BHD. They shall not be used or reproduced without or in any without permission in writing.